

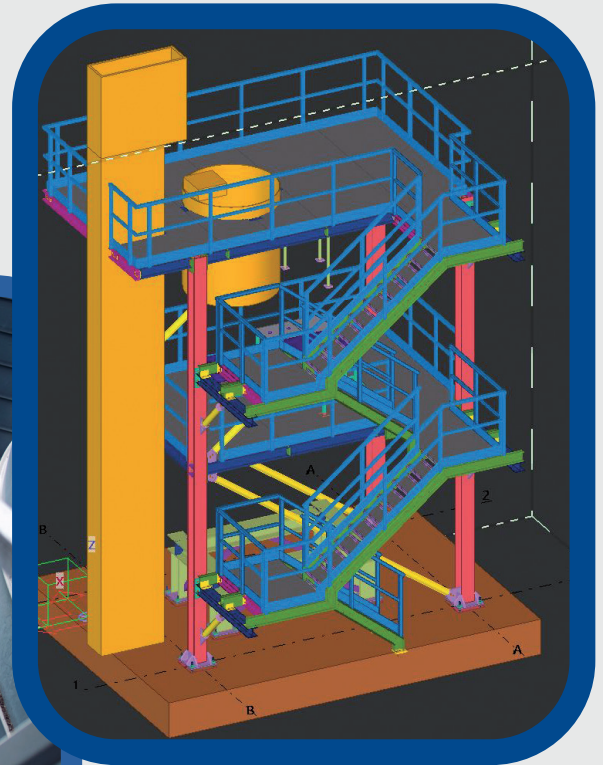

INSTALLATION OF INDUSTRIAL PLANTS

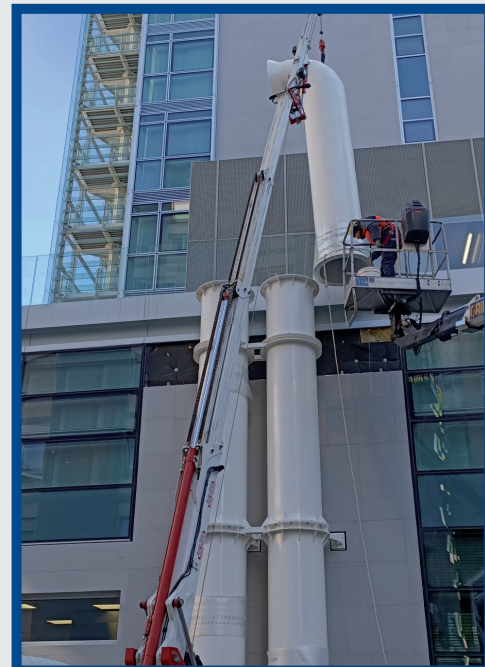

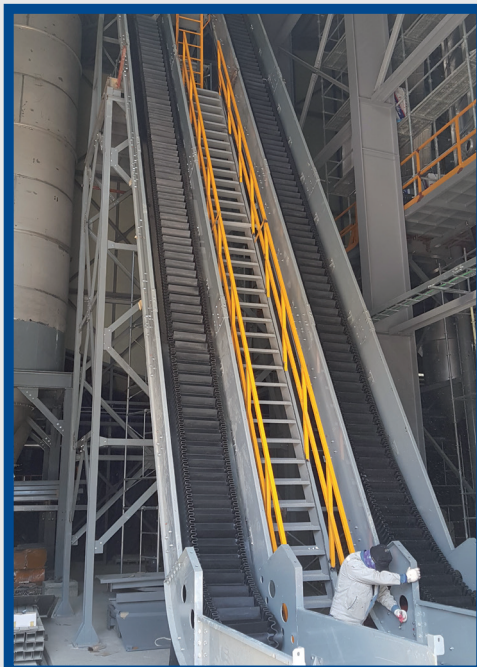

SERVICES:

Mechanical assembly of bag filters, pipes, conveyor belts, ceramic ball mill, silos, atomisers, automated systems and generally the installation of all industrial facilities, in the ceramic field, food sector, cremation and pharmaceutical sector, and the laying of earthquake-proof systems on buildings. Construction of stairs, canopies, sheds, and customised box cover made of panels or metal sheets.

OPERATORS:

Qualified technicians offer expertise to satisfy clients' requirements, performing the jobs on time and to perfection.

TECHNICAL ADVICE:

Our prerogative is to provide a complete and efficient service, offering the best solutions to achieve the set goals. We offer the possibility to design structures certified by qualified engineers both for light and heavy carpentry. We offer free on-site visits and quotations without commitment.



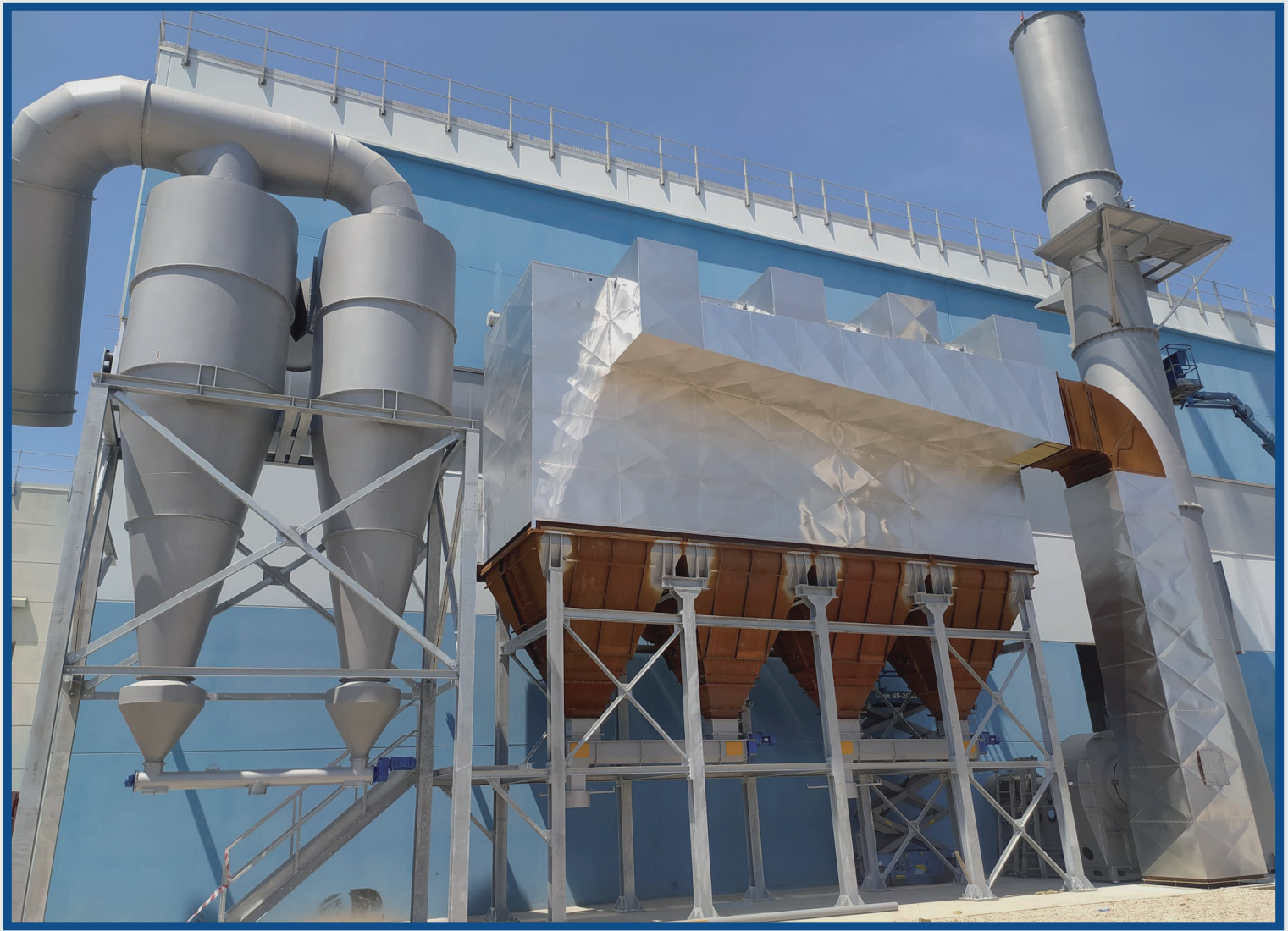



Installation of an earthquake-proof system



 **RESISTO 5.9**
il cappotto antisismico

Progetto
SISMA 

**TECNO-ART**

Via Regina Pacis, 222 - 41049 Sassuolo (MO) - Italy - Tel. +39 0536 990 422
e-mail: info@tecno-art.com - www.tecno-art.com